

Base Components: 3000 Series, 3361, 6321L

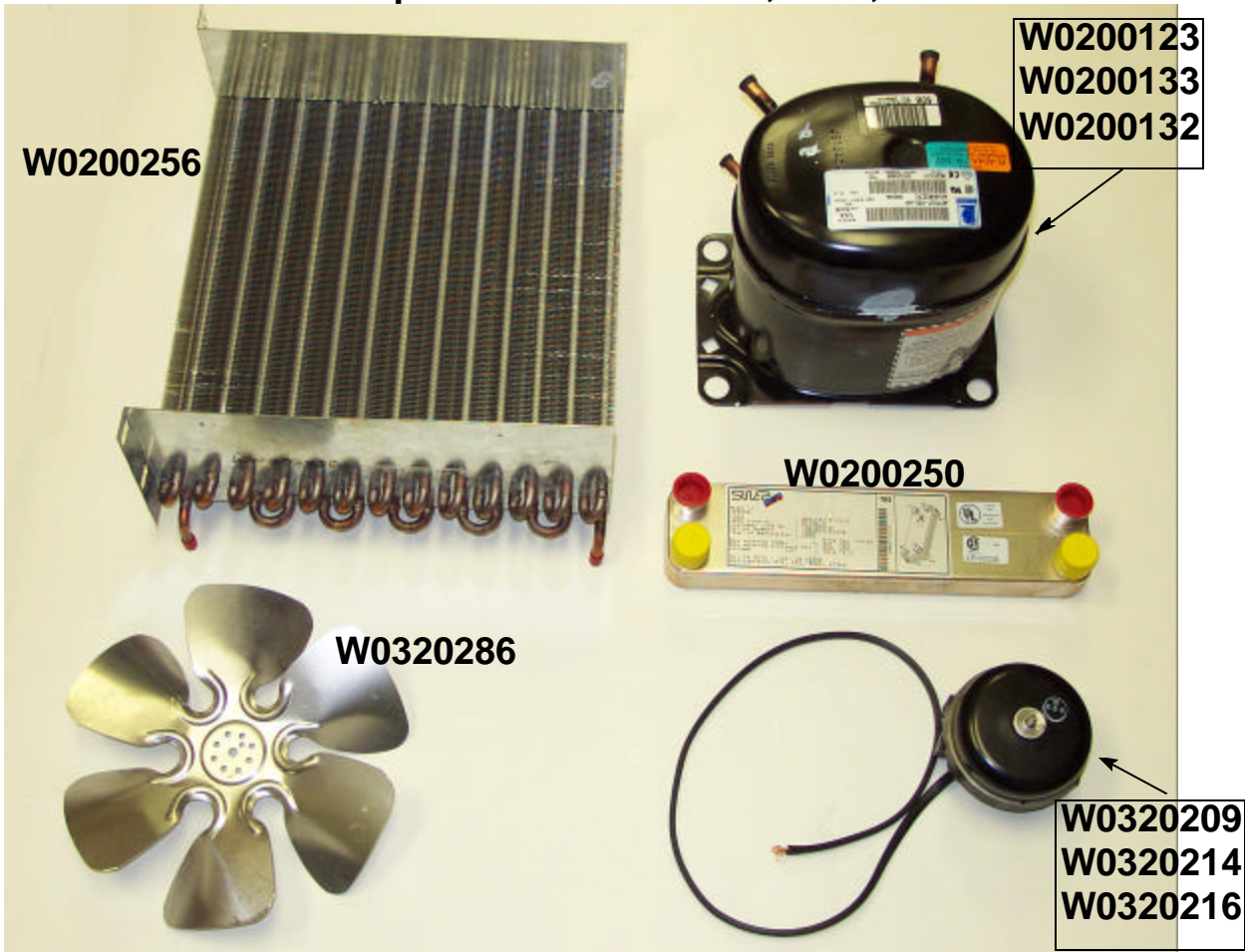

Part #	Description	Models Used On
W0200123	Compressor, 3/4 HP	115V/60Hz 3311/3312/ 3361/6321L
W0200132	Compressor, 3/4 HP	220V/50Hz 3311/ 3312
W0200133	Compressor, 1 HP	3511
W0200250	Water Cooled Condenser	W/C version 3311
W0200256	Air-Cooled Condenser	All
W0320209	Fan Motor	3311, 3312, 3361, 6321L
W0320214	Fan Motor	3511
W0320216	Fan Motor	220V/50Hz 3311/3312
W0320286	Fan Blades	All

**Dispense Valve Plunger: 3000 Series, 3721,
Remote Condenser Units**



Part #	Description
W0480438	Standard Plunger, 3000 Series
W0480451	Thick Product Plunger, 3000 Series
W0340022	O-ring, plunger

Misc. Components: 3000 Series, Remote Condenser Units, 3721, 3361, 5000 series

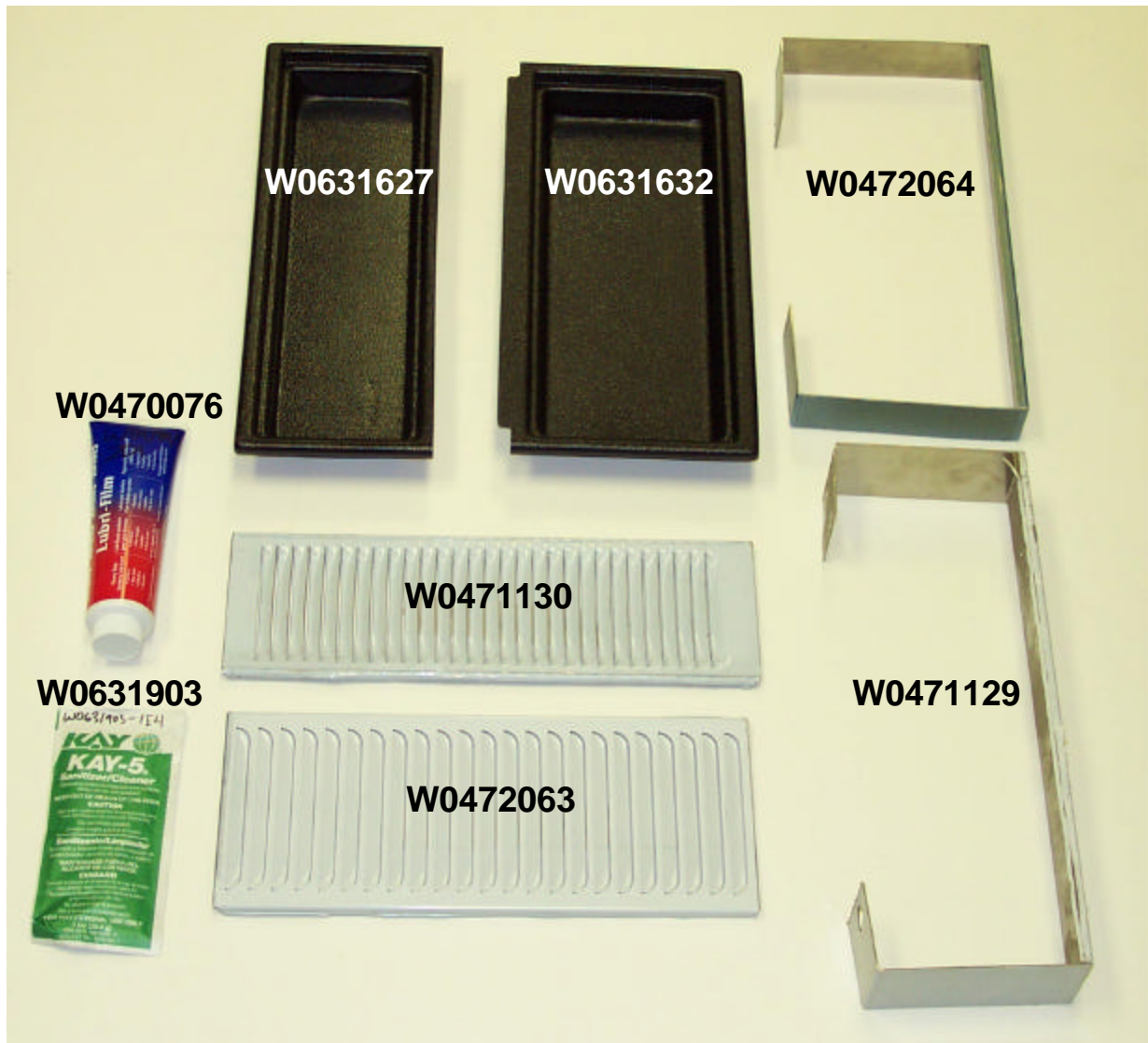

Part #	Description
W0470076	Lubricant
W0471129	Drip Pan Bracket, Twin barrel
W0471130	Drip Pan Insert, Twin barrel
W0472063	Drip Pan Insert, Single barrel
W0472064	Drip Pan Bracket, Single barrel
W0631627	Drip Pan, Twin barrel
W0631632	Drip Pan, Single barrel
W0631903	Sanitizer Packets

Hopper Covers

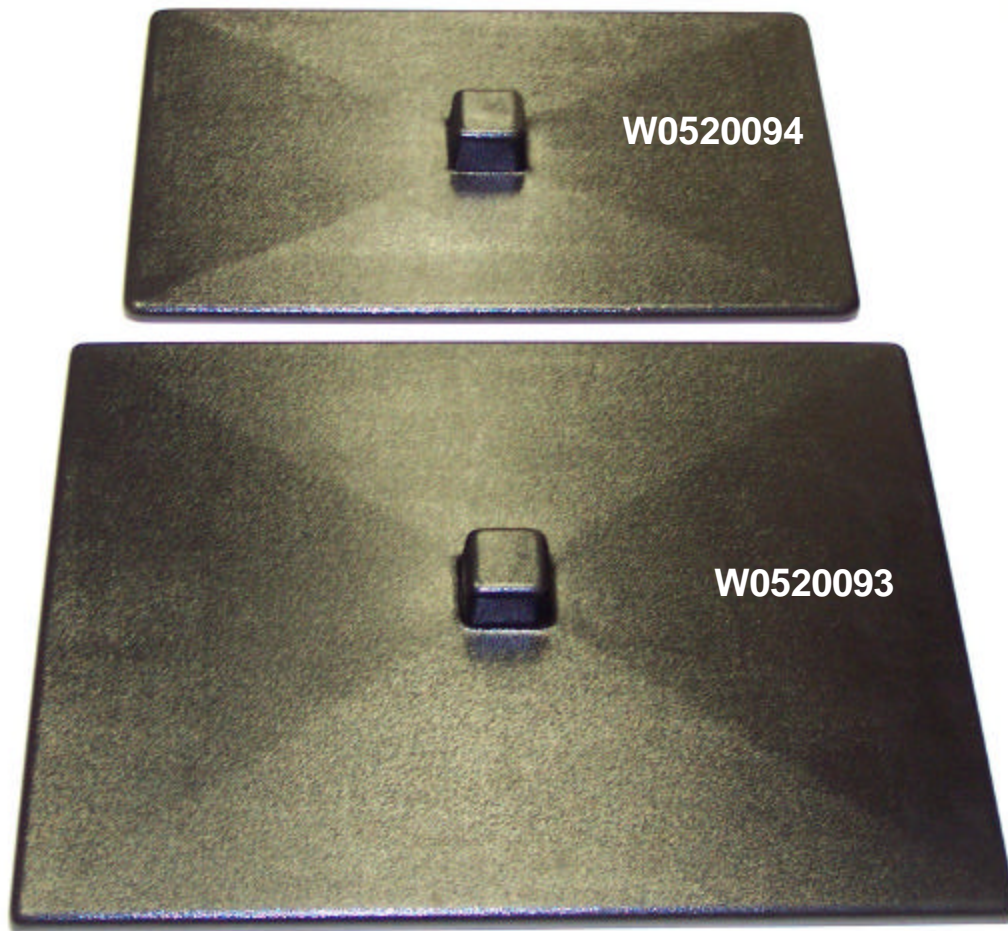

Part #	Description	Models Used On
W0520093	Hopper Cover, Twin Barrel	3312, 3342, 3352, 5512
W0520094	Hopper Cover, Single Barrel	3311, 3511, 3721, 3341, 3341A, 5311, 5511

Drive Components: Fan Motor

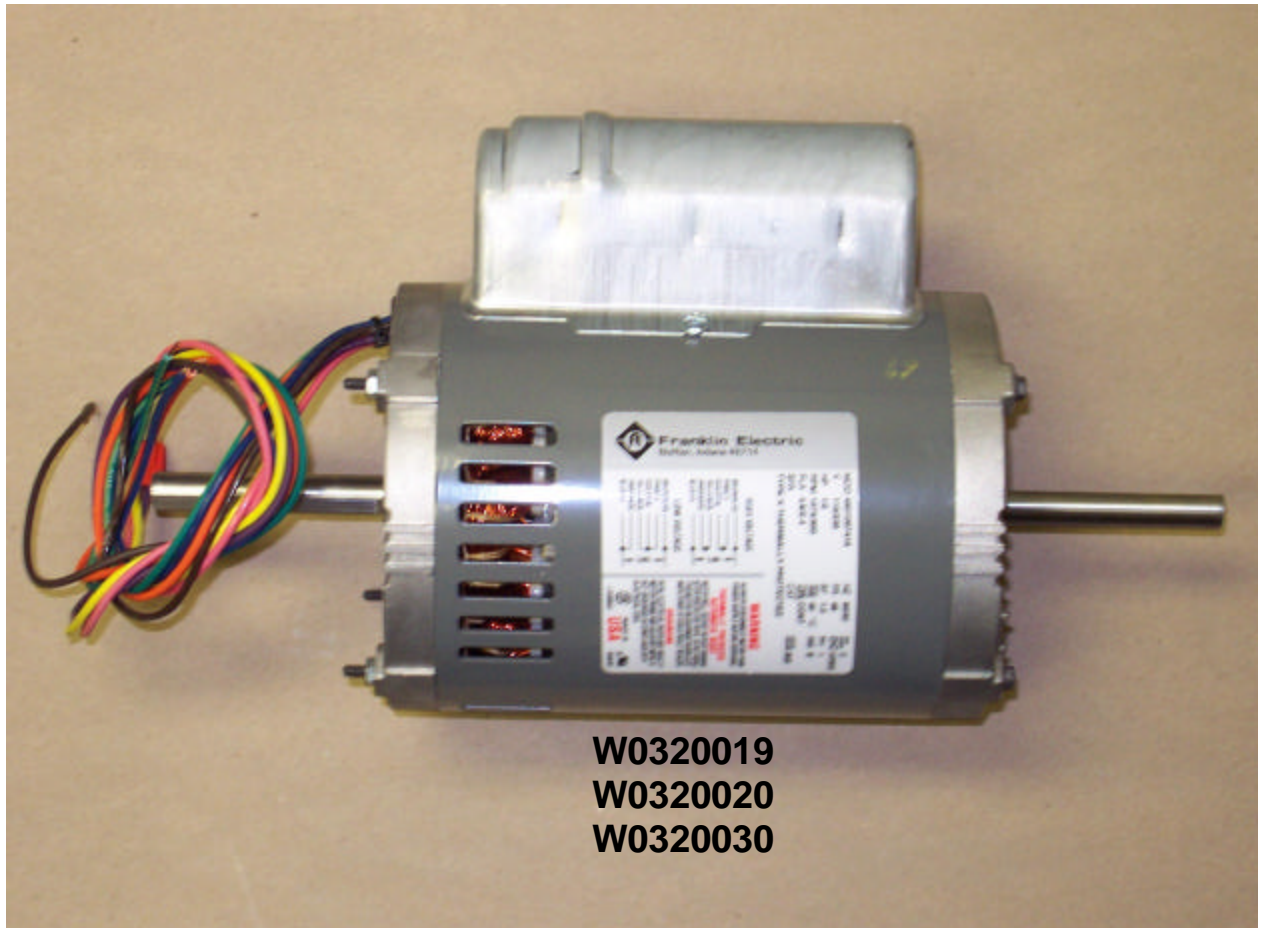

Part #	Description	Models Used On
W0320019	Motor, Franklin 1/4 Hp	3312
W0320020	Motor, drive dual cycle 1/2 Hp	3311, 3511, 3341, 3341A, 3342, 3352, 3361, 3721, 5311, 5511, 5512, 6321L
W0320030	Motor, drive 1/2 Hp	3311 220V/50, 220/60 3312 220/50 5512 220/50

Electrical Components 3000 Series, 3361, Remote Condenser Units

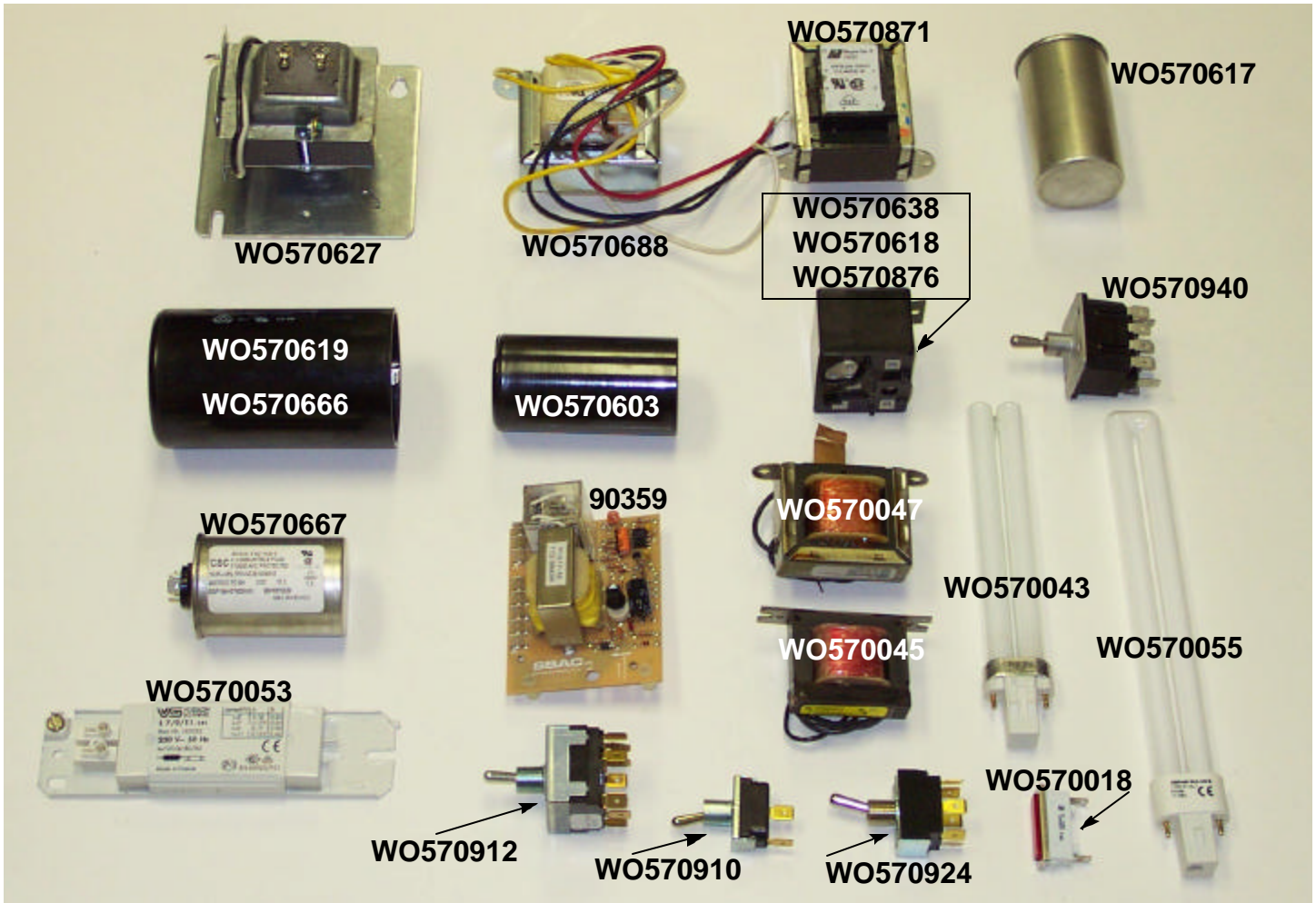

Part #	Description	Models Used On
WO570018	Mix Out Indicator Light	All
WO570043	Fluorescent Light Bulb	Single Barrel
WO570045	Ballast	110V/60Hz
WO570047	Ballast	220V/60Hz
WO570053	Ballast	220V/50Hz
WO570055	Flourescent Light Bulb	Twin Barrel
WO570603	Start Capacitor	110V/60Hz (not used on remotes)
WO570617	Run Capacitor	60Hz (not used on remotes)
WO570618	Compressor Relay	220V/60Hz (not used on remotes)
WO570619	Start Capacitor	220V/60Hz (not used on remotes)
WO570627	Transformer	120V/60Hz
WO570638	Compressor Relay	110V/60Hz (not used on remotes)
WO570666	Start Capacitor	220V/50Hz (not used on remotes)
WO570667	Run Capacitor	50Hz (not used on remotes)
WO570688	Transformer	220V/60Hz
WO570871	Transformer	220V/50Hz
WO570876	Compressor Relay	220V, 50Hz (not used on remotes)
WO570910	Autofill ON/OFF Switch	3341A, 3352
WO570912	ON/OFF Switch	3312, 3511
WO570924	ON/OFF Switch	3311, 3361, 3341A, 3352, 3342
WO570940	ON/OFF Switch	3341
90359	Autofill Control Board	3341A, 3352

Drive Components: 3000 Series, 5000 Series, Remote Condenser Units, 3721, 3361, 6321L

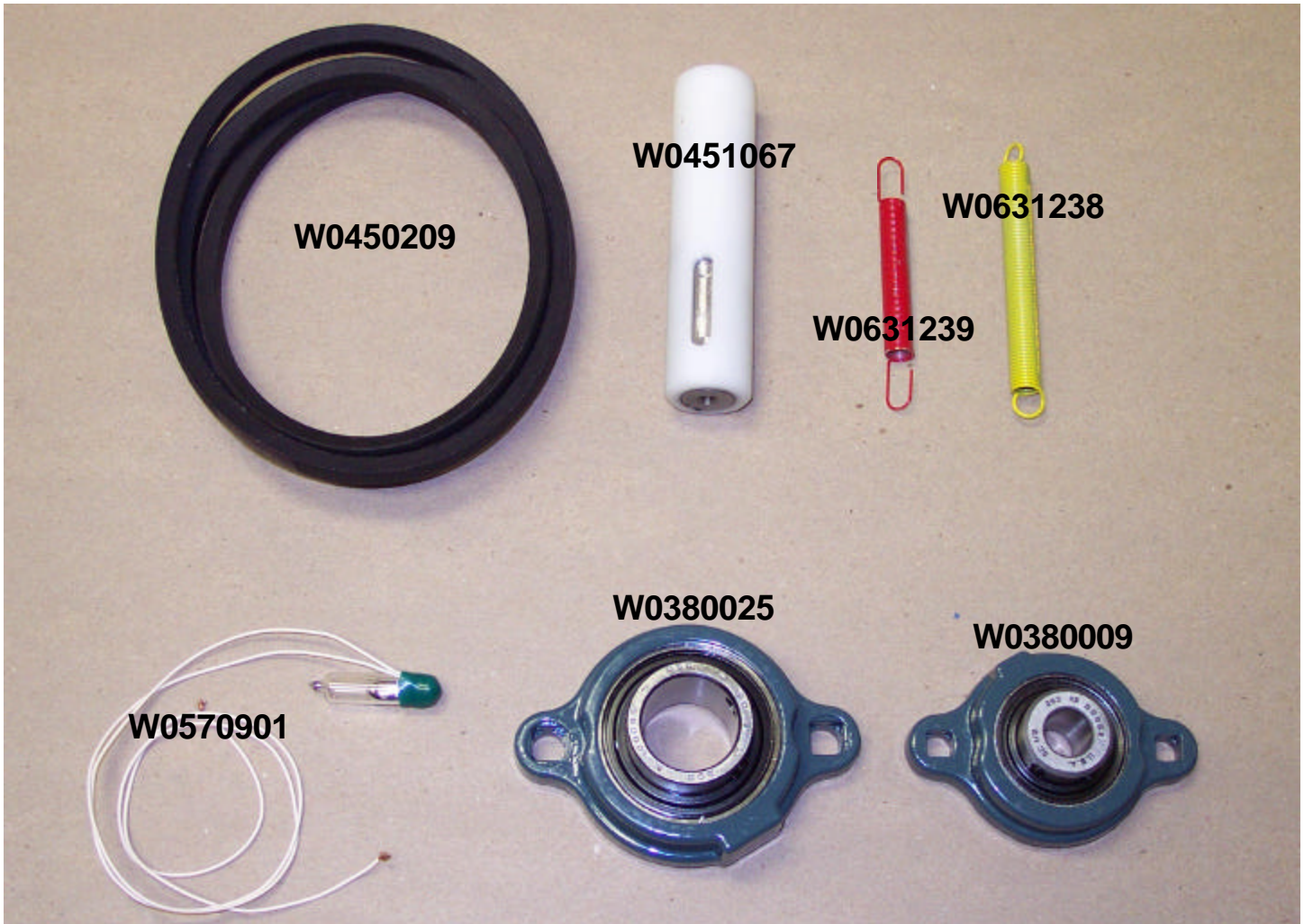

Part #	Description
W0380009	1/2" Flange bearing
W0380025	1" Flange bearing
W0450209	V-belt
W0451067	Driveshaft
W0570901	Mercury switch (not on 5000 series)
W0631238	Yellow spring (not on 5000 series)
W0631239	Red spring (not on 5000 series)

**Dispense Valve Components: 3000 Series, 3721,
Remote Condenser Units, 5000 Series**



Part #	Description
W0480450	Valve body
W0611728	Fas-pin
W0480445	Valve Handle
W0631230	Compression Spring
W0630711	D-knob
W0340058	Barrel gasket
W0340055	O-ring, valve body

Product Contact Components: 5000 Series, 3000 Series, 3721, Remote Condenser Units

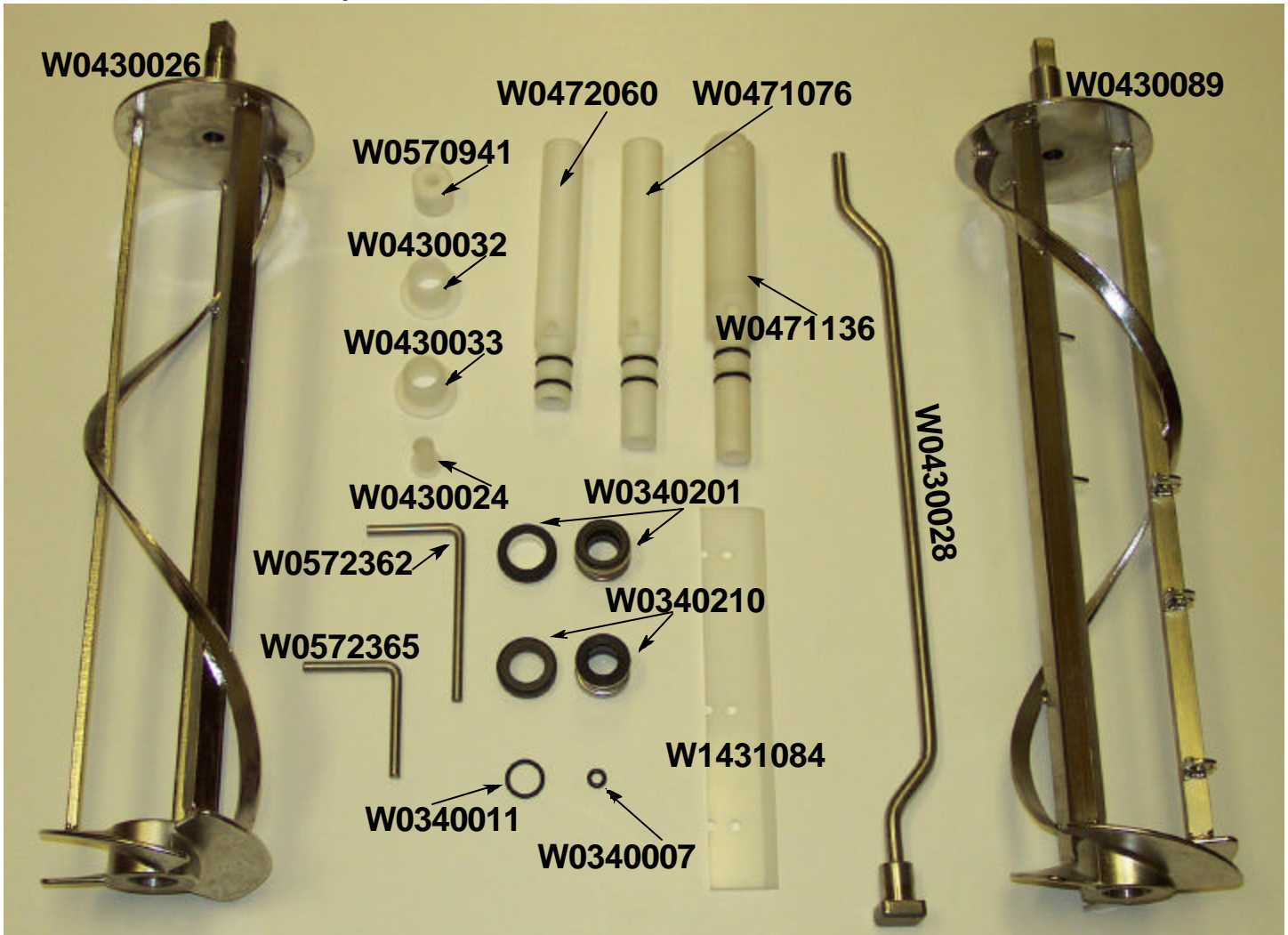

Part #	Description
W0340007	Mix Low Float O-ring (not on 5000 series)
W0340011	Carb Tube O-ring
W0340201	Standard Shaft Seal Set
W0340210	Coconut Oil Shaft Seal Set
W0430024	Rear Stator Bearing
W0430026	Standard Dasher
W0430028	Stator Rod
W0430032	Front Stator Bearing, Standard Seal
W0430033	Front Stator Bearing, Coconut Oil Seal
W0430089	Scraper Blade Dasher
W0471076	Standard Carb Tube Assy.
W0471136	Smoothie/Shake Carb Tube Assy.
W0472060	Low Overrun Carb Tube Assy.
W0570941	Mix Low Indicator Float (not on 5000 series)
W0572362	Mix Low Probe (5000 series only)
W0572365	Mix Low Probe (Remote Condenser Units only)
W1431084	Scraper Blade (only used with scraper blade dasher)