

OPERATION and SERVICE MANUAL

MAGIC MIXER MODEL K-200

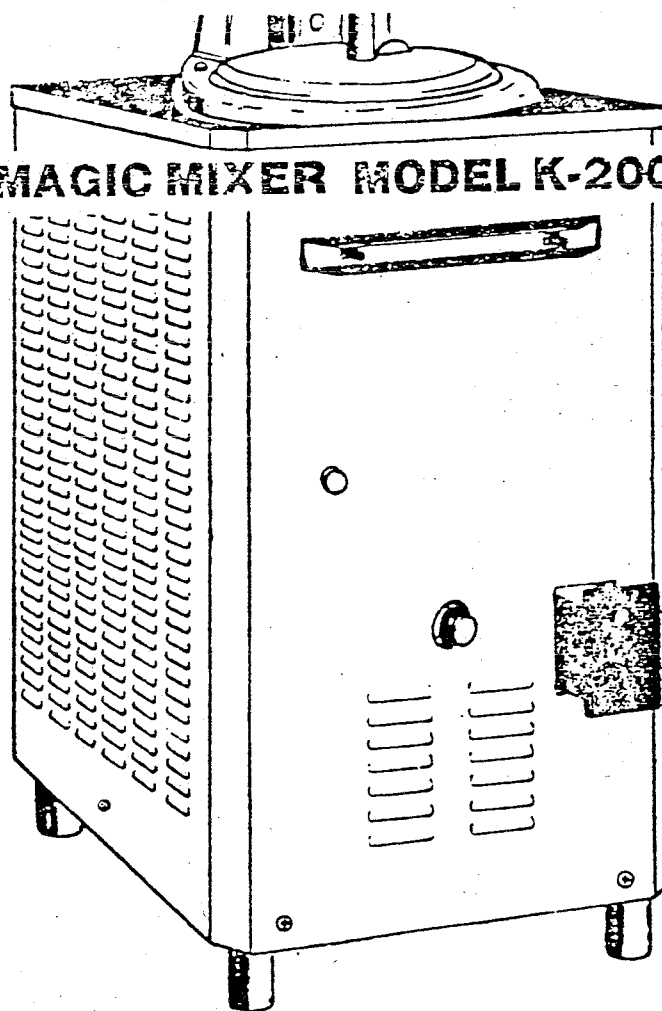

COLDELITE®

CORPORATION OF AMERICA

P. O. Box 4069 - Winston-Salem, N.C. 27115
3760 Industrial Drive - Winston-Salem, N.C. 27105
Telephone: (910) 661-9893 - Fax (910) 661-9895

5 543 100

PART I - INSTALLATION

A. Uncrating

Before discarding packing material, make certain the shipping carton does not show signs of having been dropped, tampered with, or abused in such a way as to suggest that its contents may have been damaged in transit.

IMPORTANT: In the event the outside of the carton should give any indication of possible hidden damage, so state on the Bill of Lading before signing. Contact the carrier immediately and request an inspection of the damage. Coldelite Corporation of America assumes no responsibility for damage to equipment if it is caused during transit. If the above procedure is not followed, you are responsible and will have to incur expenses for any repairs that may be required.

Proceed with the uncrating procedure as follows:

1. Remove the carton strapping. NOTE: Exercise caution when you cut the strapping as it may snap out.
2. Carefully lift the carton straight up and away from the freezer.
3. Remove all other packing material (plastic covering, corrugated protection strips, etc.).
4. Remove side panels. To remove the side panels, you must first remove the retaining screws (see Part A Figure 1). After having removed the retaining screws, lift the panels upward, then outward and down to remove (see Fig. 1 Steps 1 & 2).
5. Unfasten retaining bolts and nuts to free machine from the skid. The unit is fastened to the skid with four (4) bolts located at each corner of the lower frame.
6. Do not remove the wood support blocks located between the bottom of the frame and top of skid. Carefully turn the machine until one corner is clear of the skid. Fasten one caster to this corner. To install casters, simply screw caster threaded rod into machine shipping bolt holes (See Fig. 3). Follow the same procedure for the remaining casters until the skid can be completely removed.

CAUTION: Do not allow the front or rear panels to support the weight of the machine as possible damage to the panels may result.

7. Once the machine is set in position, it must be leveled as accurately as possible. Adjustments can be made by adjusting caster height.

8. Free compressor by loosening all four (4) of the compressor tie down nuts. The compressor should float freely on mounting springs. Clearance between the rubber grommet and retaining nuts should be approximately 1/16".
9. Remove all stainless steel protection covering by simply peeling off.
10. On air cooled models, remove the protective cardboard from the condenser at the rear of the machine. The air flow is from the sides to back and there must be a minimum of 20" of open area behind the freezer and 6" on the sides.

B. Water Connection—(Water Cooled Machines)

Units with water cooled condensers will have a 1/2" male pipe thread fitting marked "Water Inlet" and one marked "Water Outlet". The water inlet may be further identified by looking inside the cabinet and determining it is connected to the water valve. Plumbing may be easily connected to the machine using standard fittings. High pressure hoses may be used (when permitted by local code). To connect machine to water supply and drain, a filter (or strainer) and a shut-off valve should be provided on the water supply line to the machine. The drain line from the 1/2" M.P.T. fitting must be run into a suitable drain. An open drain is preferable for future checks and for its anti-siphon effect (check local plumbing code).

IMPORTANT: If the machine is stored at freezing temperatures (32°F/0°C or below) the cooling system (condenser and compressor) must be drained.

To drain, air pressure should be blown through the system, with the water valve open, from the machine water inlet. This operation should be performed by your authorized Coldelite service technician.

WARNING: If not properly drained before cold storage, your machine can be seriously damaged.

C. Ventilation - (Air Cooled Machines)

The back of air cooled machines must be kept at least 20" from the wall or any object that could obstruct the air flow from the condenser. Best efficiency and greater output will be achieved when the machine is installed in a cool, well ventilated room.

D. Electrical Connections

All wiring should be completed in accordance with the NATIONAL ELECTRICAL CODE and/or local electrical codes, rules and regulations.

MINIMUM ELECTRICAL REQUIREMENTS

Model	Compressor Motor	Beater Motor	F.L.A.		Wire Gauge		Fuse Size
			1 PH.	3 PH.	1 PH.	3 PH.	
	1-1/2 HP	3/4HP	11.4	15.2	#8	#10	30Amp

(Refer to name plate for additional data)

Power Supply Must be adequate to meet requirements at all times. With the machine in operation voltage fluctuations should not exceed $\pm 10\%$ of the normal or rated voltage.

NOTE: Warranties are voided if the actual voltage (at extreme reading) applied to the K-200 is not within 10% of voltage specified on data plate.

Adequate Wiring Should be provided with regard to wire size of gauge. Unless otherwise required by the local electrical code, the wire gauge at the machine junction box should be used for the direct power line. (see min. electrical requirement chart). A separate circuit breaker, with adequate fuse protection, should be employed.

An unfused disconnect switch or proper size plug-in, close to the freezer, is recommended.

Coldelite freezers are provided with protection on the beater motor. Should the line voltage drop or if there is a short circuit, the overload protector will automatically disconnect the starter and the machine will stop immediately so that no permanent damage can be caused to the motor. To start the freezer again, push the RESET button (see Fig. 2) located on the front panel of the machine. The compressor is also internally protected. If the Klixon protector trips due to an overload, the klixon automatically resets and the compressor will be re-activated.

Connection A 4x4 junction box, located in the lower left hand corner of the front panel, is provided for hook-up (see Fig. 3). To gain access to the junction box, the front panel must first be removed. To remove the front panel, first remove drip tray (see Fig. 2), then remove the four (4) panel retaining screws (see Fig. 1 Part No.B), pull bottom of the panel outward and downward. The junction box will now be visible and connection can be completed.

NOTE: In all installations, both single and three phase, the machine must be properly grounded. Since all electrical components are connected by means of flexible conduit, adequate ground continuity is assured by running and fastening a ground line to the machine junction box.

Motor Rotation (3 Phase Units Only- Ref. Fig. 4)

When installing a "3 phase" machine, the beater motor must be checked for proper rotation. Rotation MUST be in a clockwise direction as indicated by the "Arrows" on the beater flywheel. To check rotation, remove the motor and flywheel cover (Ref. Fig. 2) by first removing the cover retaining knob and then lifting cover off. Turn "mixer" on/off switch to the "on" position. Beater motor is now on and rotation can be checked.

Caution Make sure to stay clear of pulleys, belts, and beater blade when checking rotation. Also, make certain there are no foreign objects in the mixing cylinder.

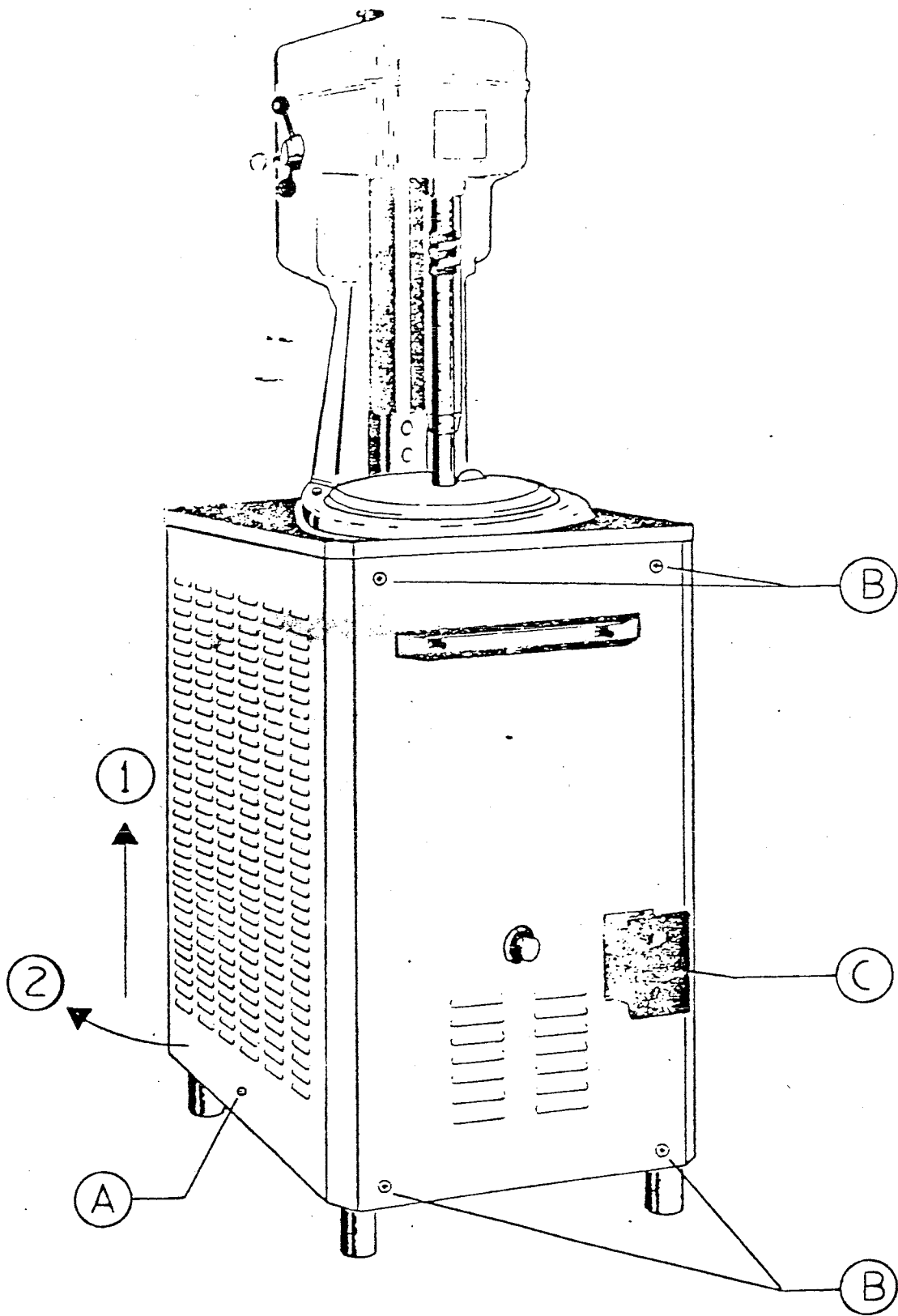

FIGURE 1

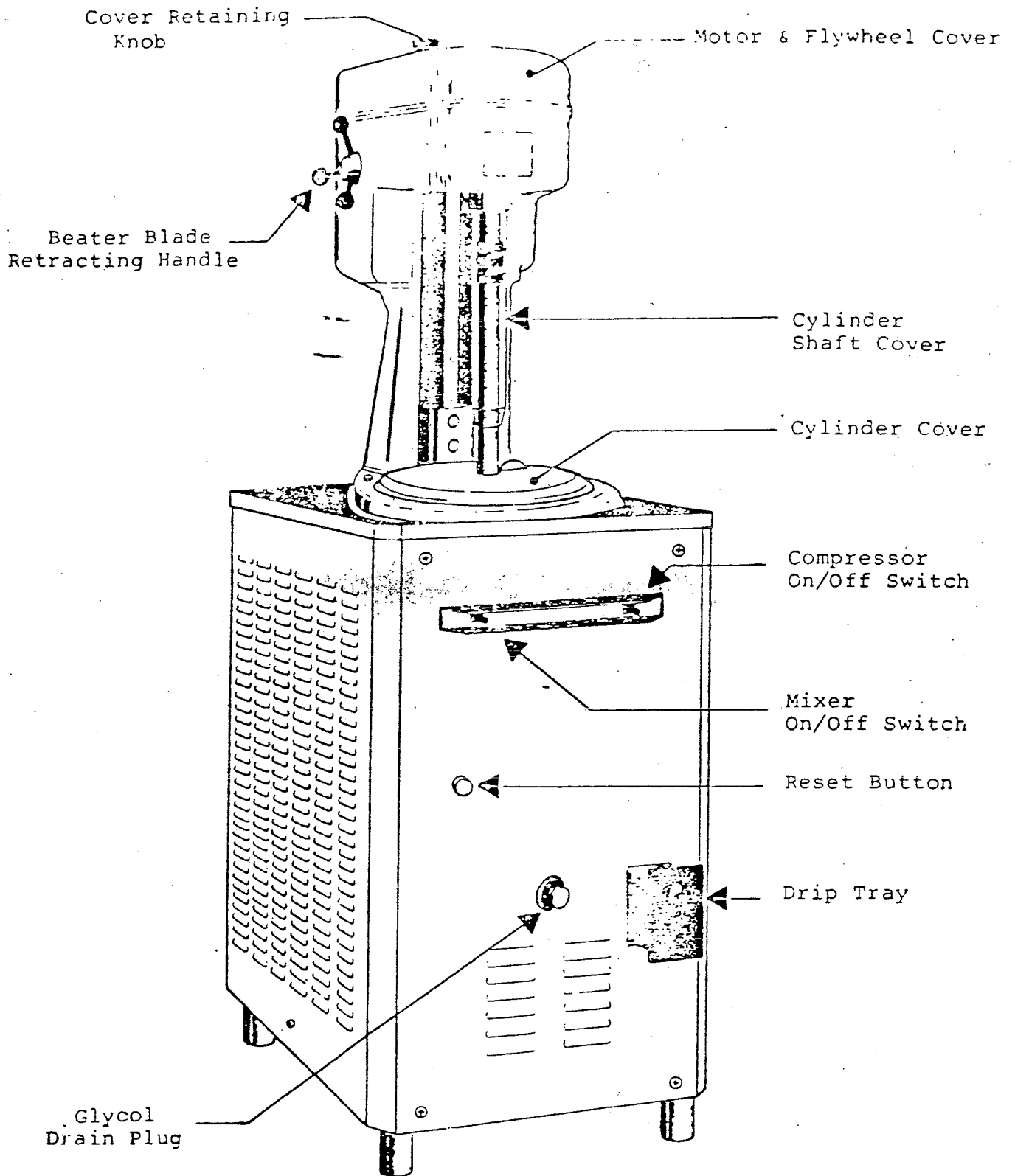

FIGURE 2

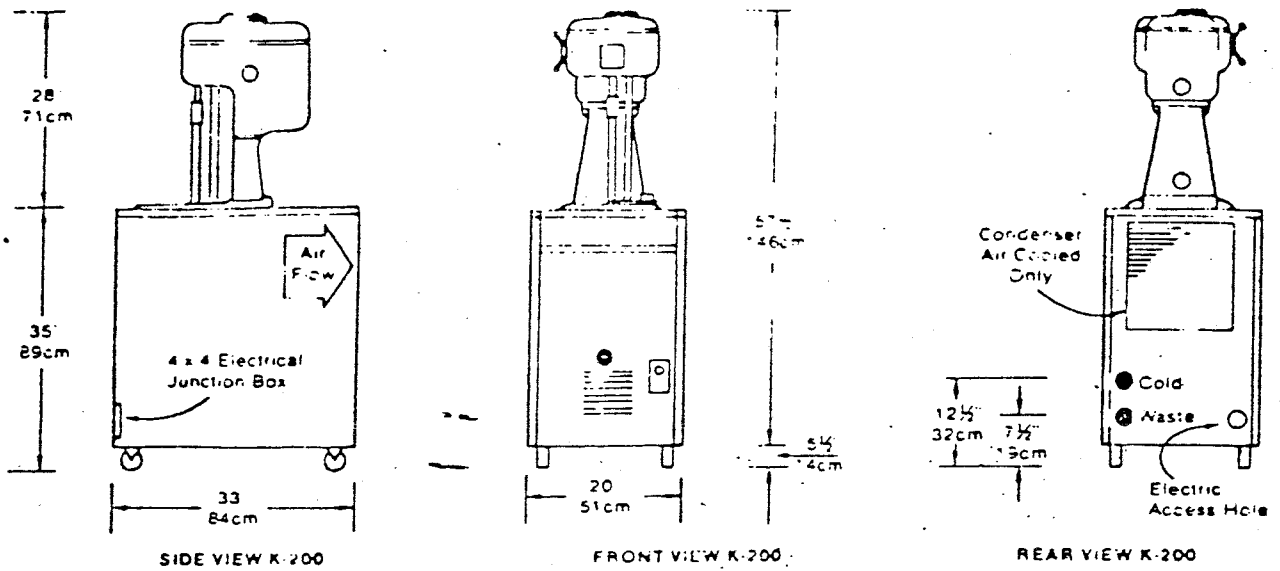
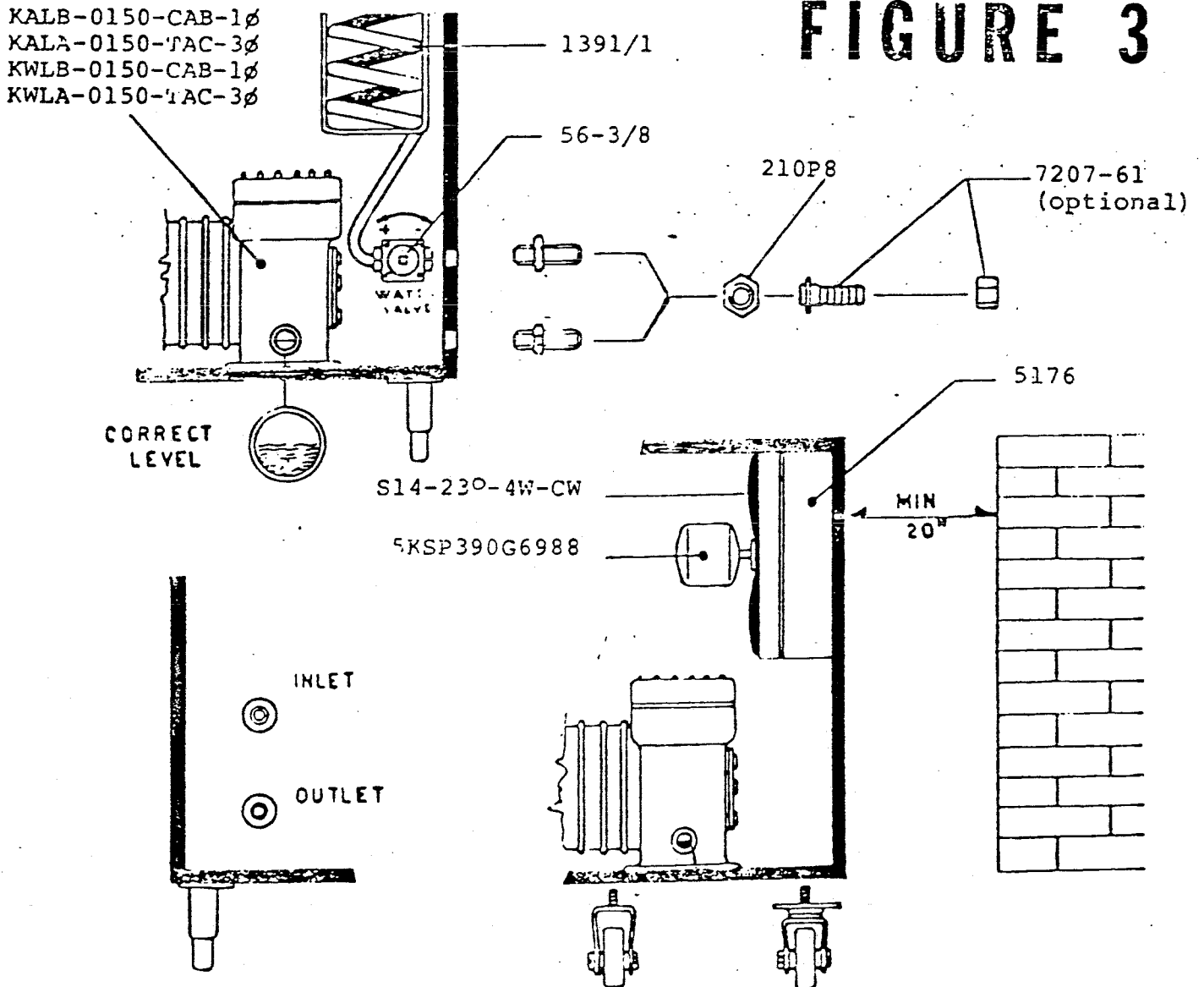
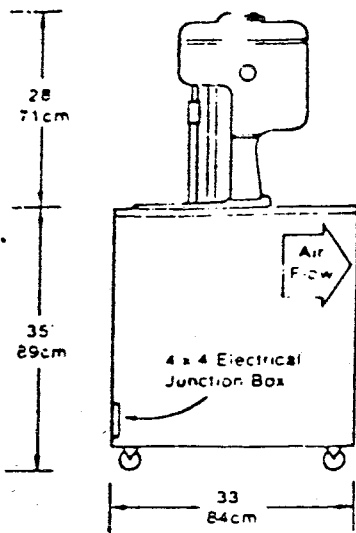
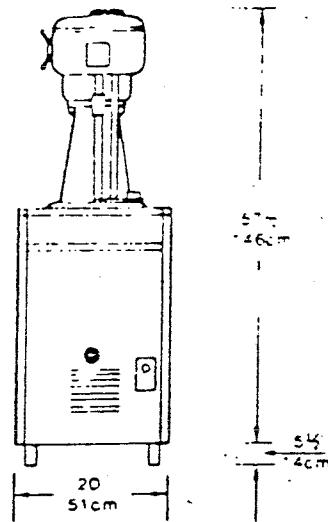

FIGURE 3





SIDE VIEW K-200



FRONT VIEW K-200

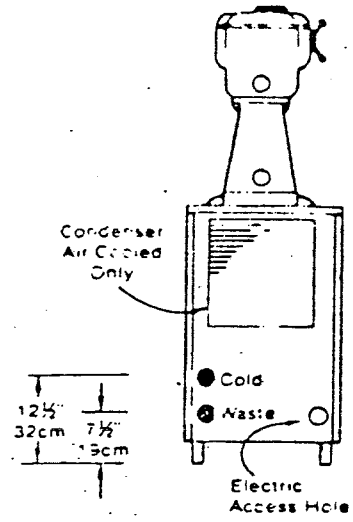

REAR VIEW K-200

FIGURE 3

KALB-0150-CAB-1ø
 KALA-0150-TAC-3ø
 KWLB-0150-CAB-1ø
 KWLA-0150-TAC-3ø

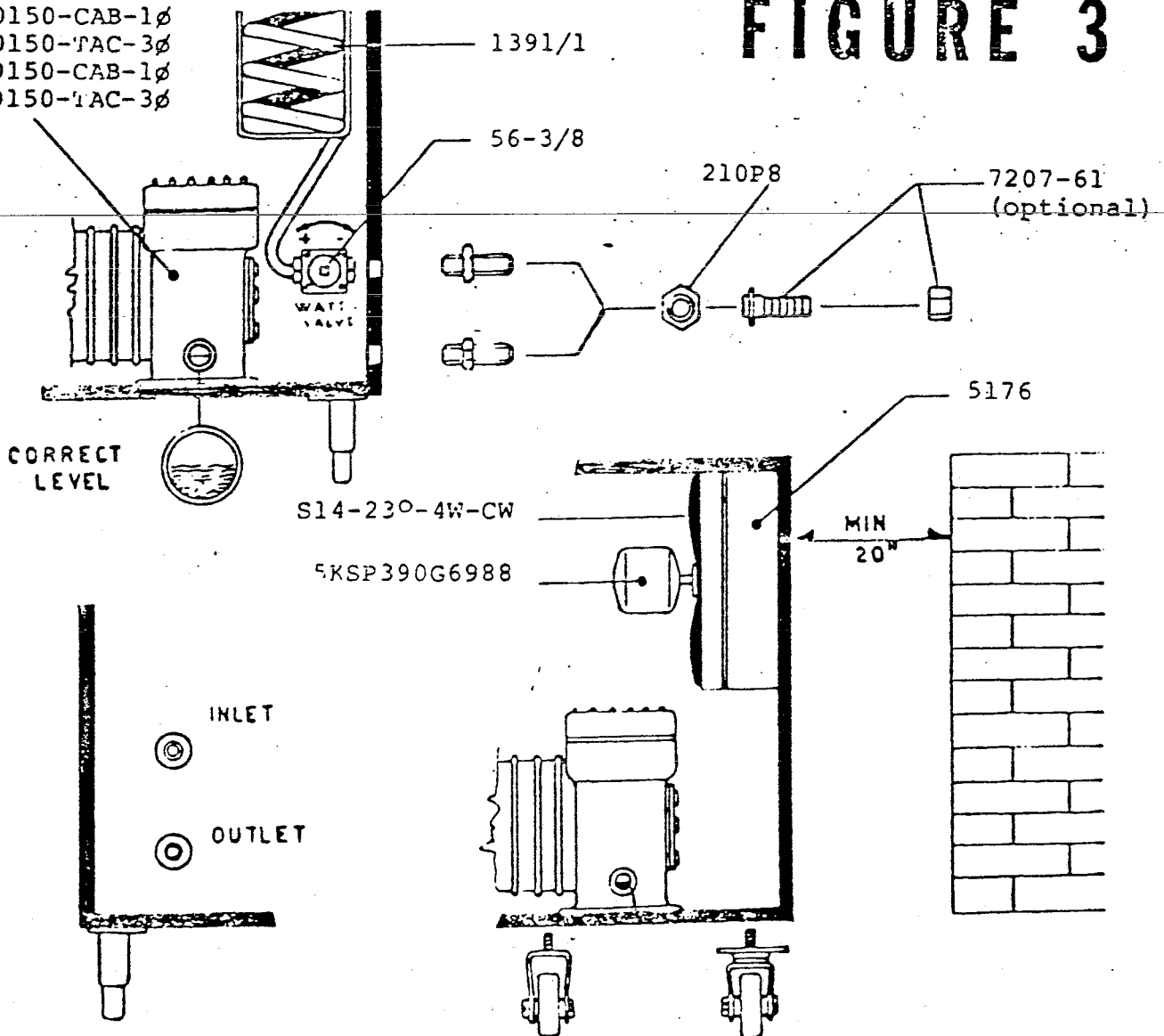

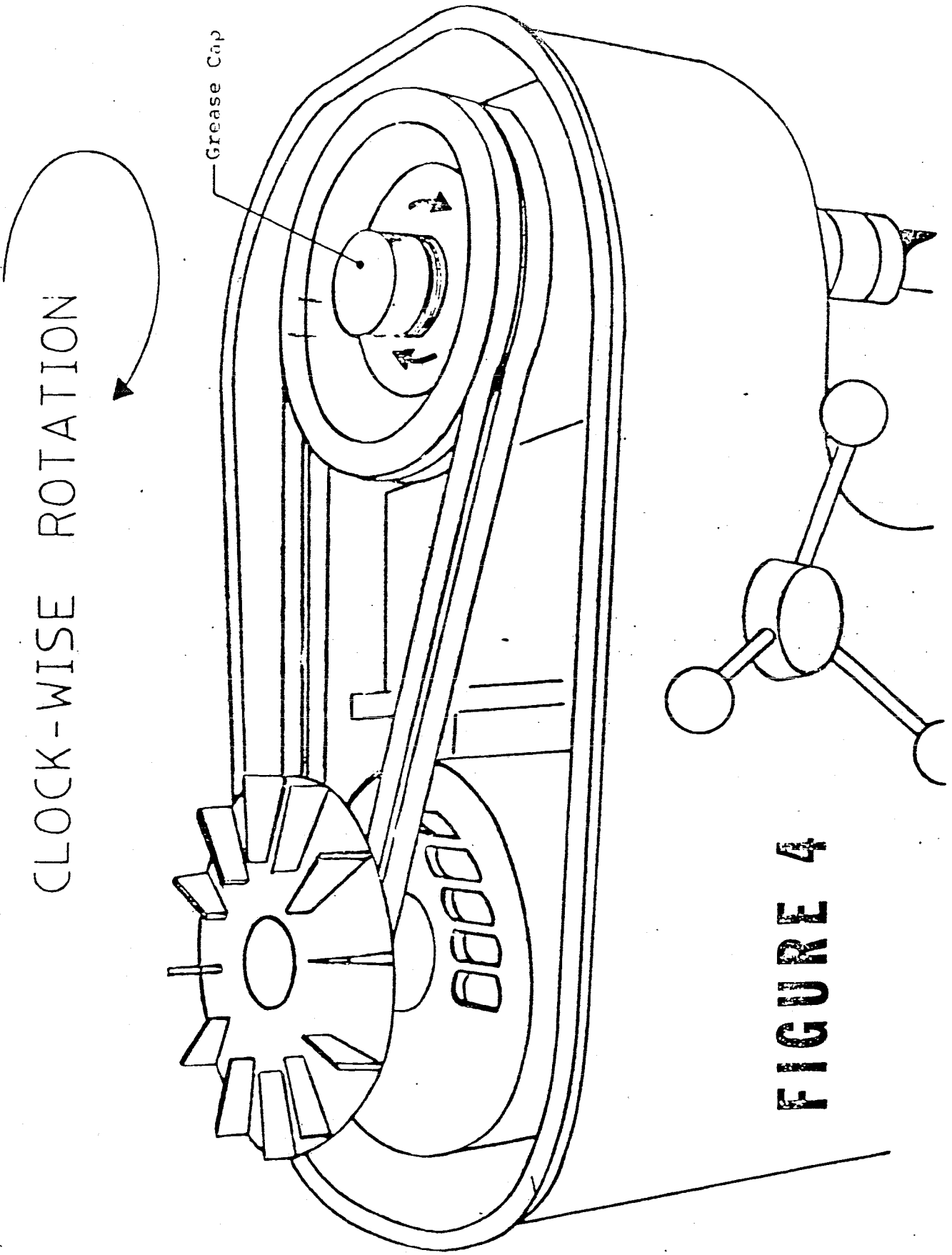

CLOCK-WISE ROTATION

Grease Cap

FIGURE 4

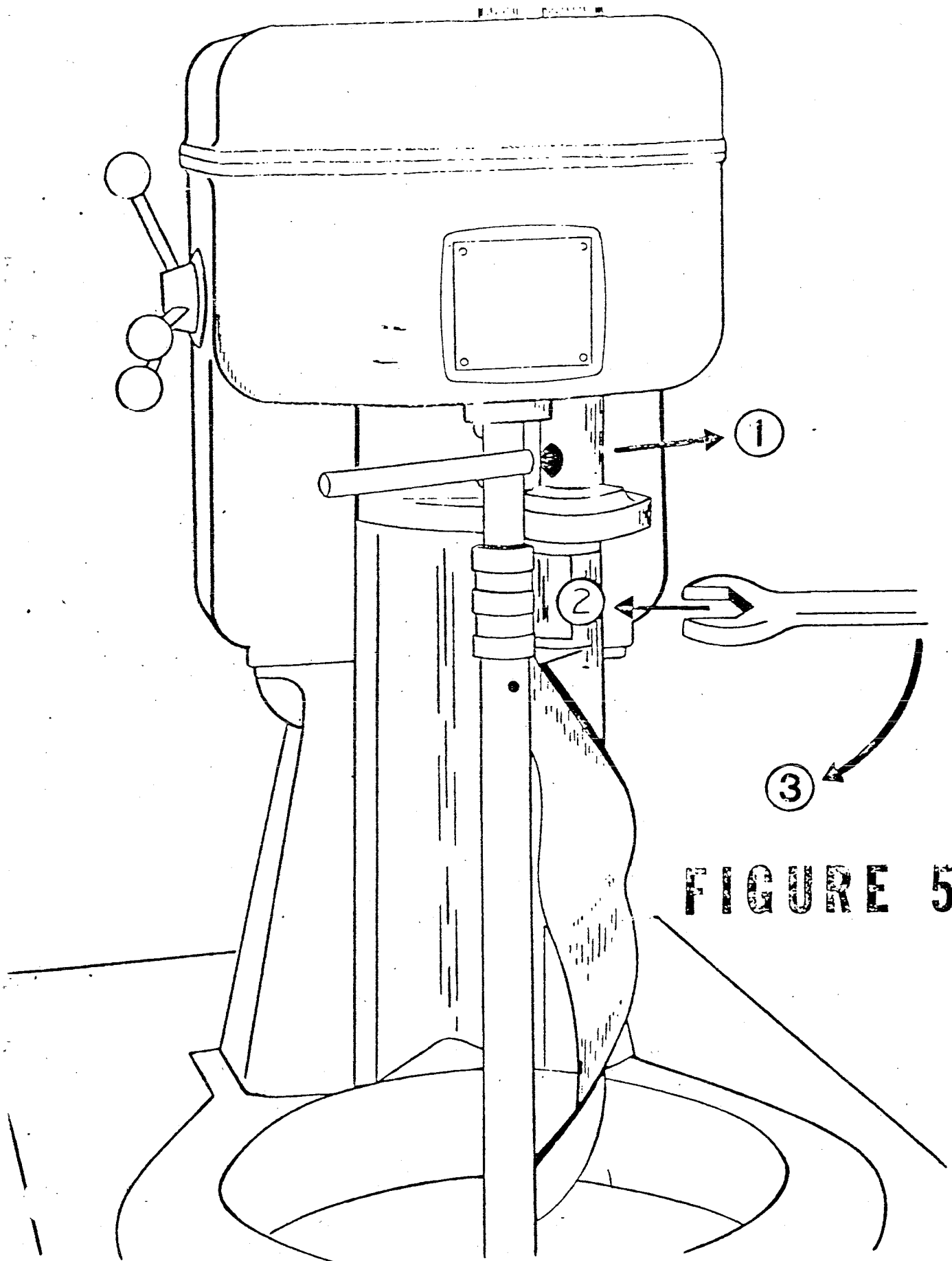

FIGURE 5

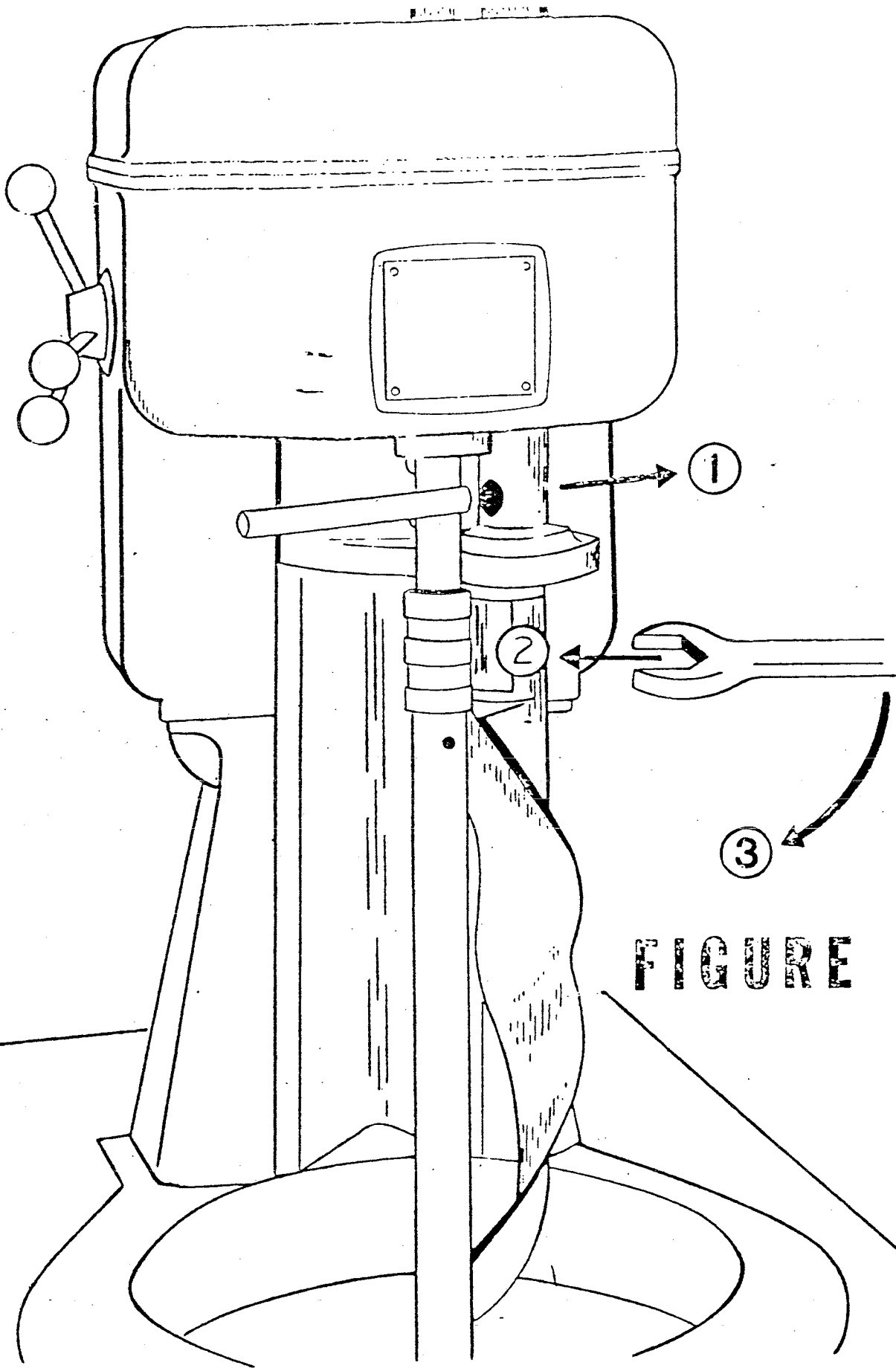

FIGURE 5

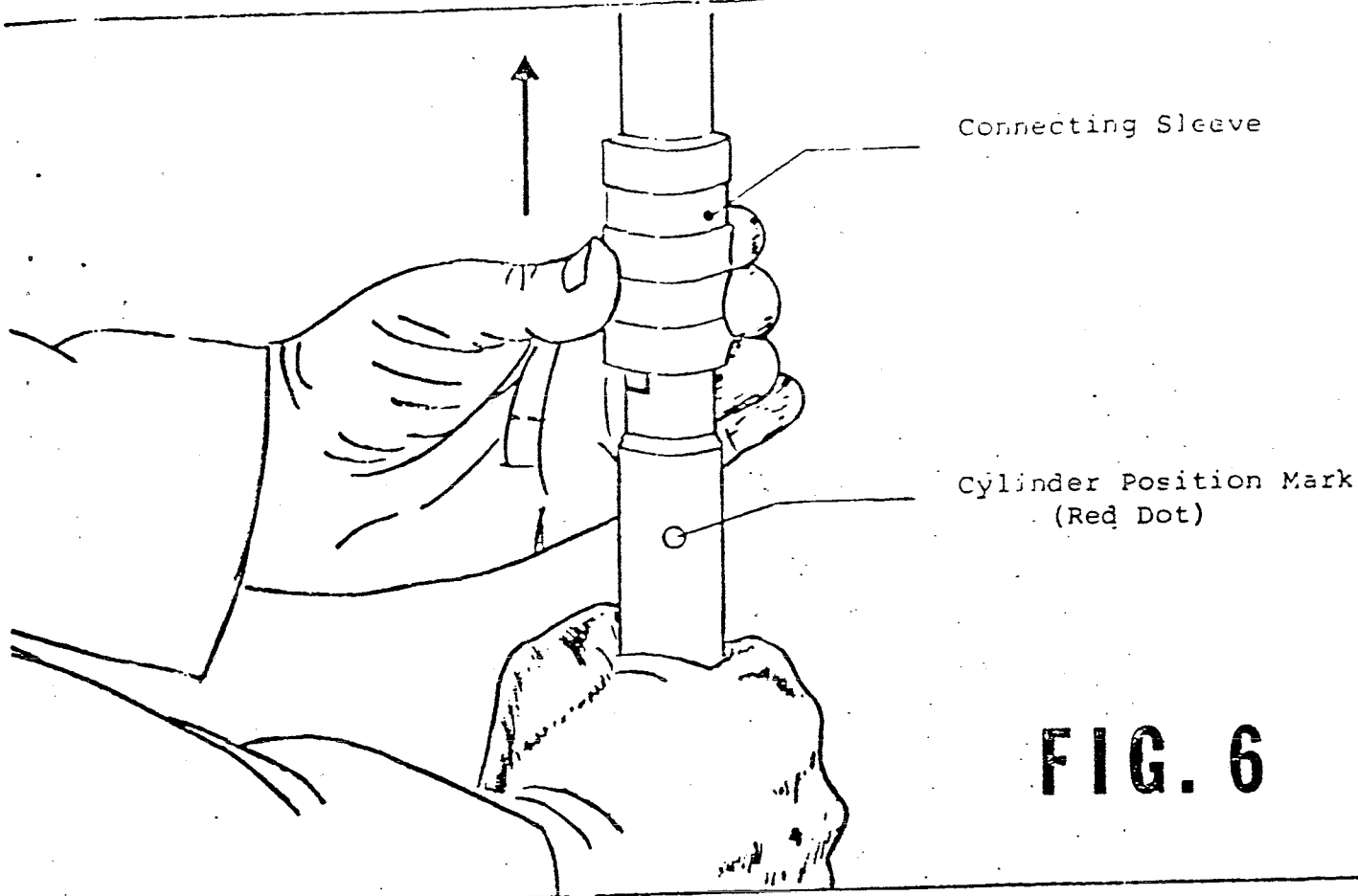

FIG. 6

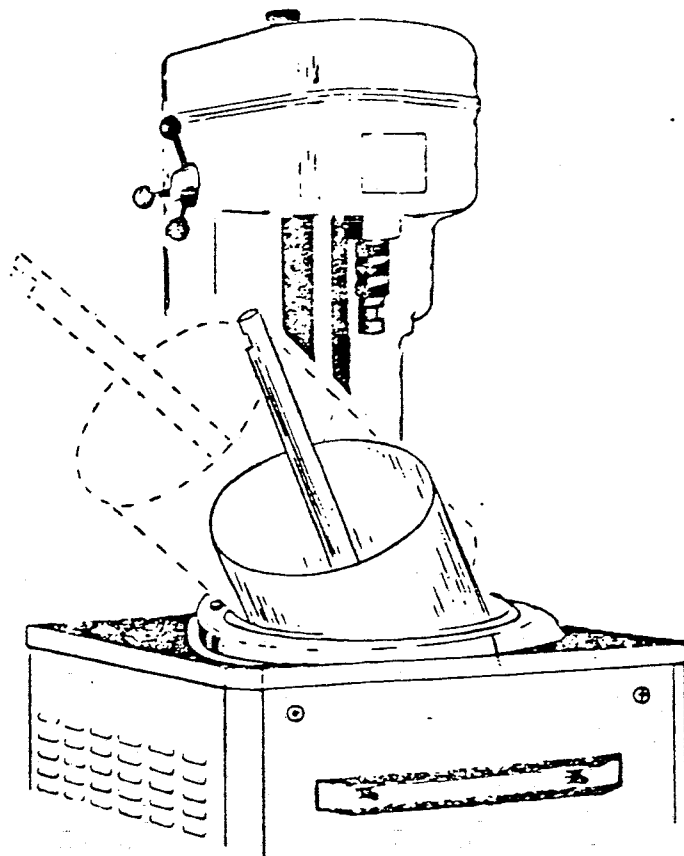

FIG. 7

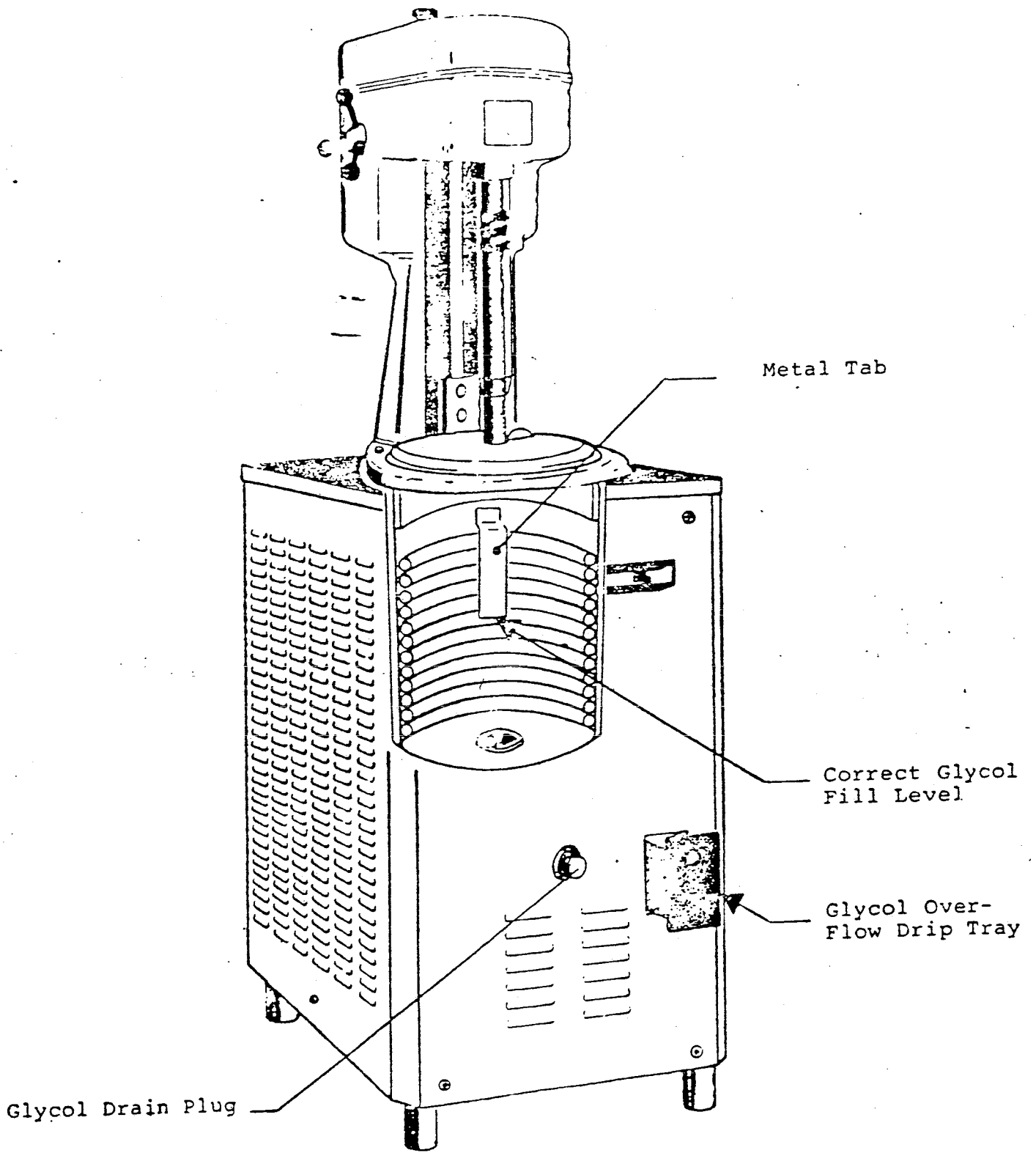
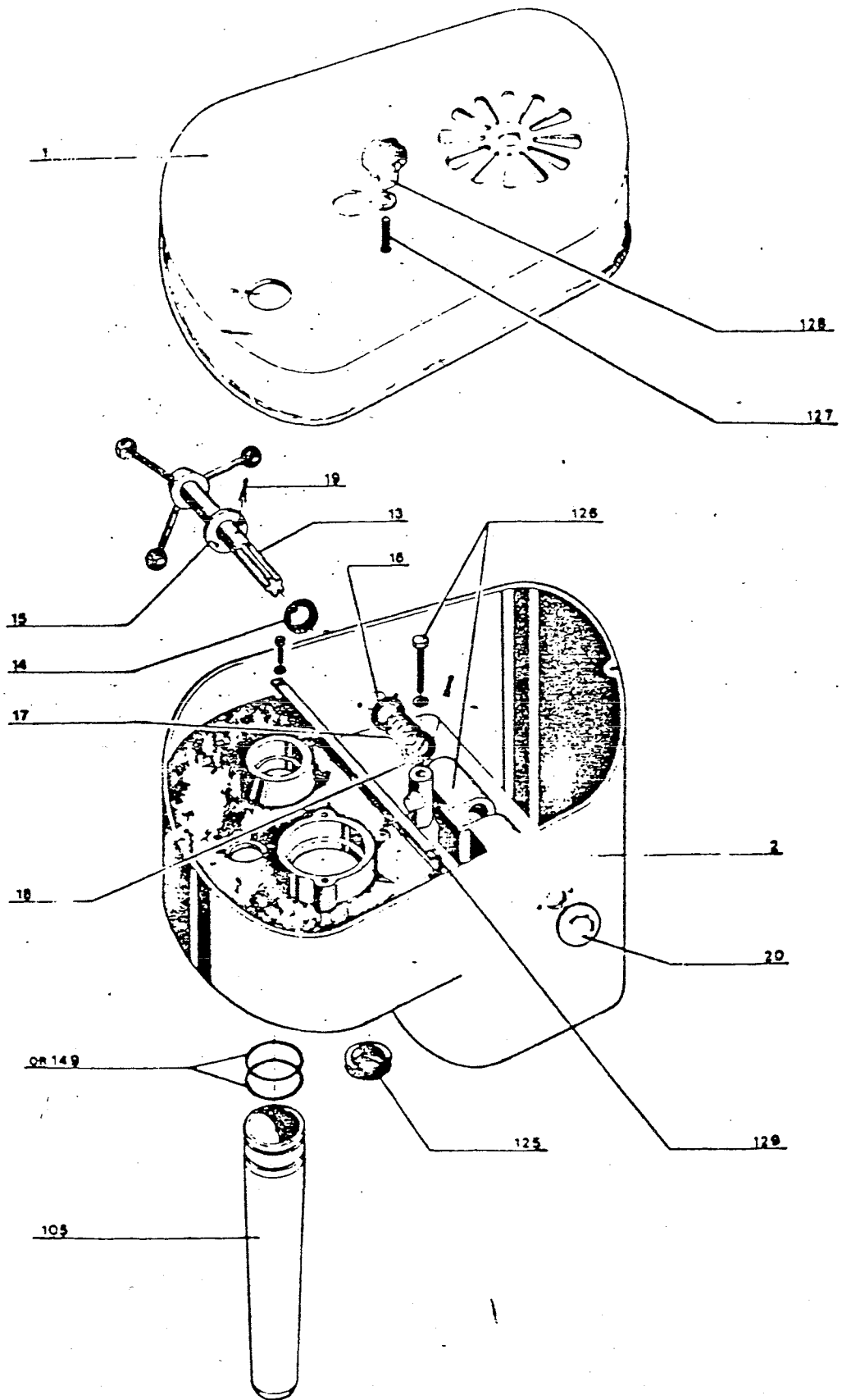
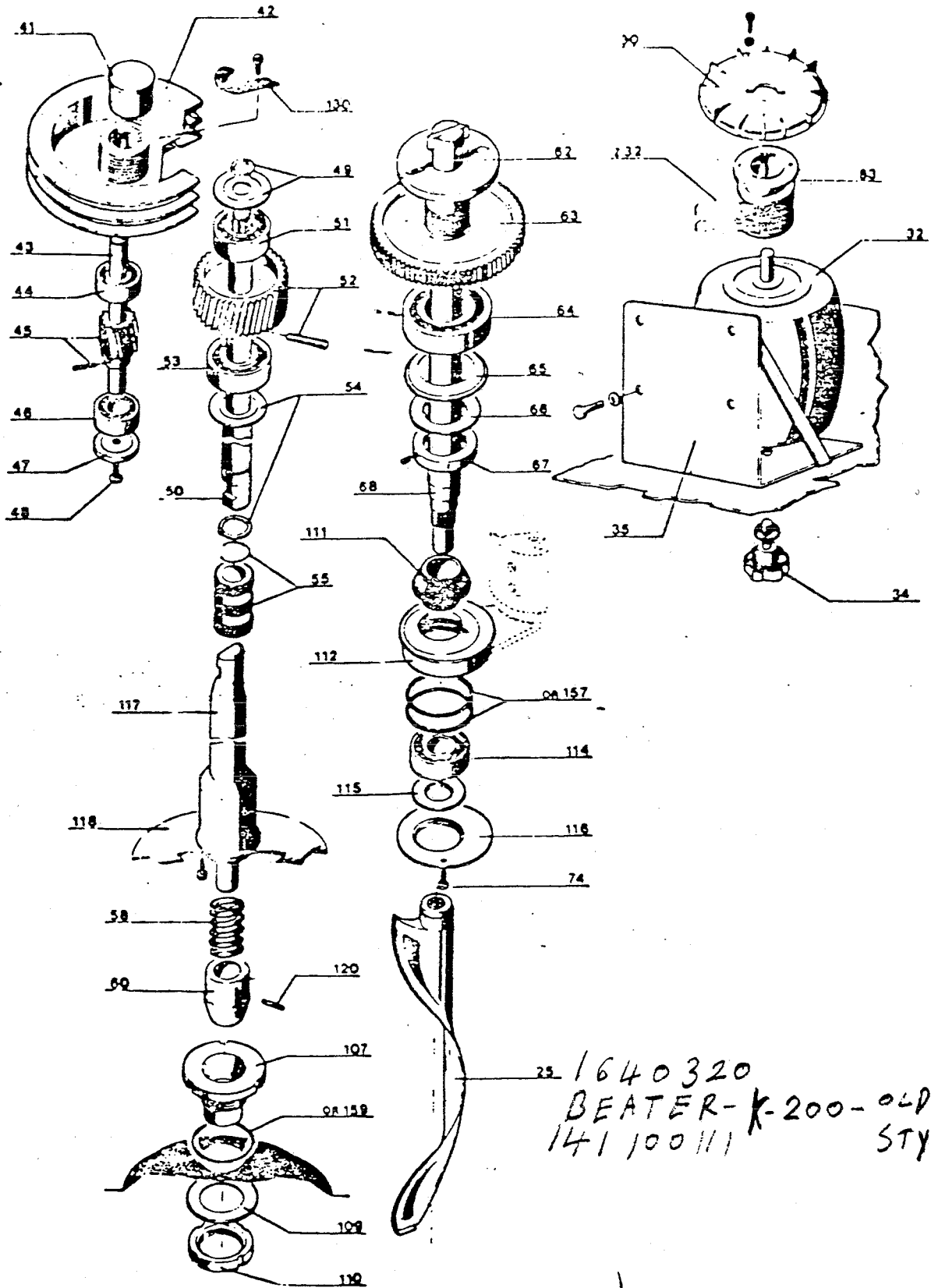
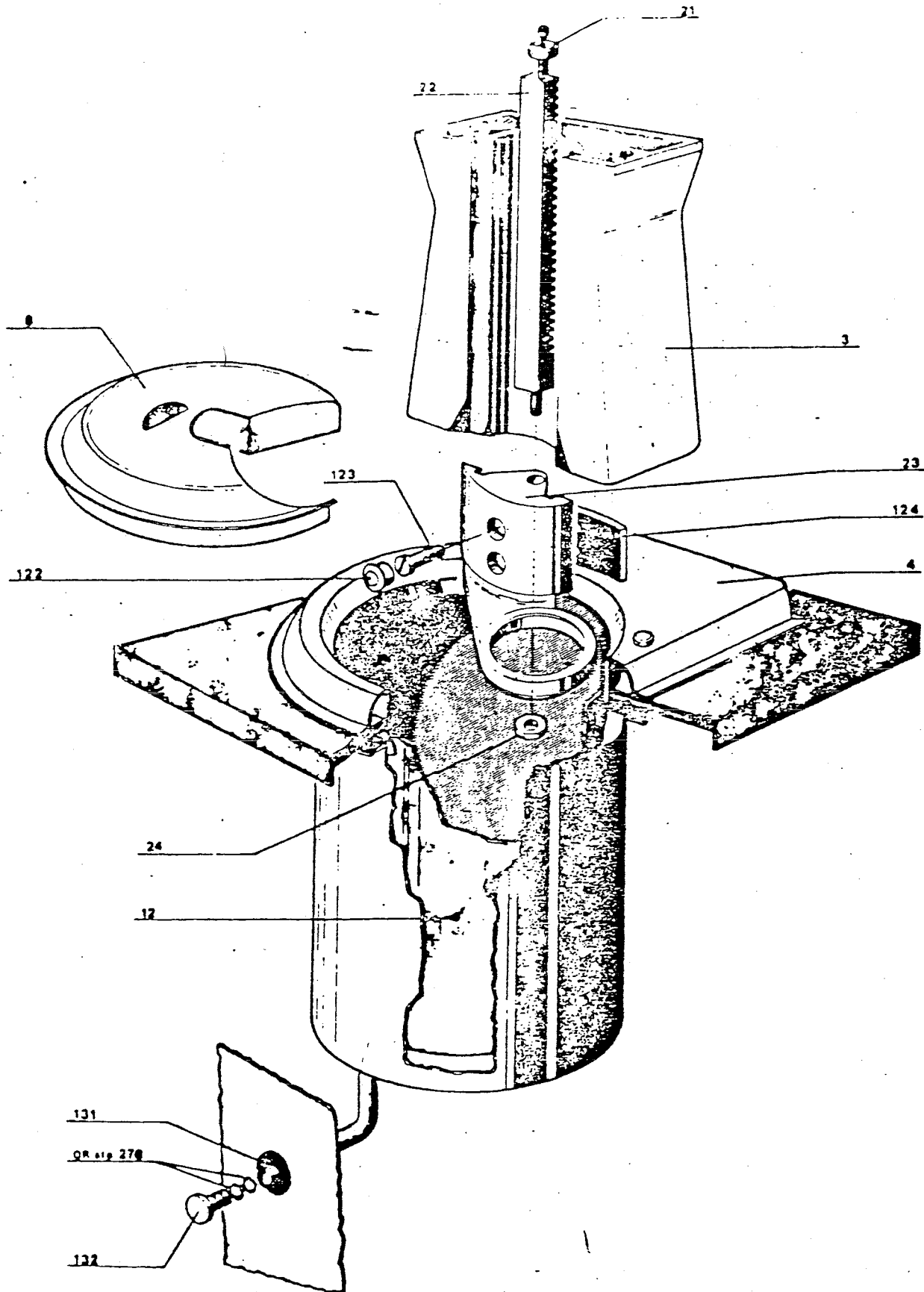

FIGURE 8





29 1640320
 BEATER-K-200-OLD
 141100111
 STYLE



412 -

